

> **Utensili Vari**
Other Tools
其它气动工具

20 90 626

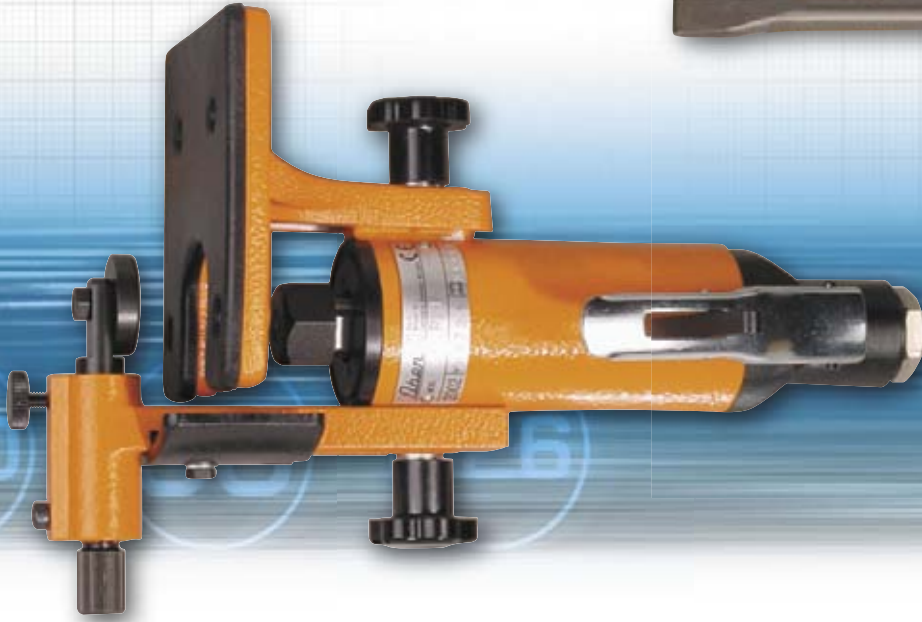

Martelli

Hammers

Meißelhämmer

DIRITTI STRAIGHT HAMMERS STABHAMMER



Modello Model Modell	Codice Code Bestellnr.	N. colpi No. strokes Schlagzahl min.	Attacco utensile (esagonale) Tool fitting (hexagonal) Werkzeugaufnahme (Sechskant) mm	Lunghezza Length Länge mm	Corpo Body Gehäuse ø mm	Peso Weight Gewicht kg	Attacco aria Air connection Luftanschluss 1/4" GAS	Tubo Hose Schlauch ø min mm	Consumo aria Air consumption Luftverbrauch NI/min
MAC2DA	8501103	7000	9	208	38	1,5	1/4" GAS	6	240

A PISTOLA GUN HAMMERS PISTOLENHAMMER



Modello Model Modell	Codice Code Bestellnr.	N. colpi No. strokes Schlagzahl min.	Attacco utensile (cilindrico) Tool fitting (cylindrical) Werkzeugaufnahme (zylindrisch) mm	Lunghezza Length Länge mm	Corpo Body Gehäuse ø mm	Peso Weight Gewicht kg	Attacco aria Air connection Luftanschluss 1/4" GAS	Tubo Hose Schlauch ø min mm	Consumo aria Air consumption Luftverbrauch NI/min
MAC33	8501005	3500	10	185	38	1,4	1/4" GAS	6	320
MAC33 Extra *	8501006	3500	10	185	38	1,4	1/4" GAS	6	320

* In valigetta di metallo e cinque scalpelli di corredo - In metal carrying case and with set of five chisels - Im Metallkoffer mit fünf Meißeln im Lieferumfang.

A PISTOLA GUN HAMMERS PISTOLENHAMMER



Modello Model Modell	Codice Code Bestellnr.	N. colpi No. strokes Schlagzahl min.	Attacco utensile (cilindrico) Tool fitting (cylindrical) Werkzeugaufnahme (zylindrisch) mm	Lunghezza Length Länge mm	Corpo Body Gehäuse ø mm	Peso Weight Gewicht kg	Attacco aria Air connection Luftanschluss 1/4" GAS	Tubo Hose Schlauch ø min mm	Consumo aria Air consumption Luftverbrauch NI/min
MAC22	8501008	5000	10	155	38	0,9	1/4" GAS	6	180



Rivettatrice

Riveter

Nietwerkzeug



Modello Model Modell	Codice Code Bestellnr.	Velocità a vuoto No-load speed Leerlaufdrehzahl giri-rpm-U /min	Lunghezza Length Länge mm	Corpo Body Gehäuse ø mm	Peso Weight Gewicht kg	Attacco aria Air connection Luftanschluss	Tubo Hose Schlauch ø min mm	Consumo aria Air consumption Luftverbrauch NI/min	Potenza Power Leistung watt
RIV33-2000	8302083	670	282	38	1,14	1/4" GAS	6	680	300

Stilo marcatrice

Engraving stylus

Gravierstift



Modello Model Modell	Codice Code Bestellnr.	Lunghezza della corsa Stroke length Hub mm	Frequenza della corsa Stroke frequency Schlagfrequenz Hz	Lunghezza Length Länge mm	Corpo Body Gehäuse ø mm	Peso Weight Gewicht kg	Attacco aria Air connection Luftanschluss	Tubo Hose Schlauch ø min mm	Consumo aria Air consumption Luftverbrauch NI/min	dB (A)
G-4	8501106	1	600	140	20	0,15	1/4"	6	360	78

Seghetto alternativo

Hacksaw

气锯



Modello Model 型号	Codice Code 编号	N. corse No. strokes 每分钟往复次数 ... / min.	Corsa Stroke 行程 mm	Lunghezza Length 长度 mm	Corpo Body 直径 ø mm	Peso Weight 重量 kg	Attacco aria Air 空气接口	Tubo Hose 气管 ø min mm	Consumo aria Air consumption 空气消耗 NI/min	Potenza Power 功率 watt
SATT300	8401003	12000-14000	10	260	38	0,5	1/4" GAS	6	250	300

Rifilatori

Trimmers

Kantenfräsen

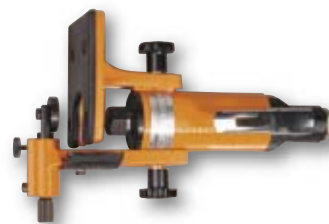

Modello Model Modell	Codice Code Bestellnr.	Velocità a vuoto No-load speed Leerlaufdrehzahl giri-rpm-U /min	Fresa Miller Fräser ø mm	Lunghezza Length Länge mm	Corpo Body Gehäuse ø mm	Peso Weight Gewicht kg	Attacco aria Air connection Luftanschluss 1/4" GAS	Tubo Hose Schlauch ø min mm	Consumo aria Air consumption Luftverbrauch l/min	Potenza Power Leistung watt	Pinza standard Standard collet Standard Spannzange ø mm	Pinza a rich. Optional collet Zusatzzange ø mm	dB (A)
RL1	8150501	20000	22	210	43	0,9	1/4" GAS	8	430	260	6	1/4"	83
RL2	8150502	18000	22	230	50	1,2	1/4" GAS	8	480	330	6	1/4"	83

Accessori per martelli

Hammer accessories

Zubehör für Hämmer

Scalpello da taglio
Cutting chisel
Schneidmeißel

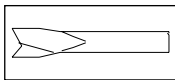

Scalpello piatto
Flat chisel
Flachmeißel

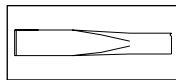

Scalpello per saldatura
Welding chisel
Schweißmeißel



MAC 2 DA	MAC 22/33	MAC 2 DA	MAC 22/33	MAC 2 DA	MAC 22/33
3285951	3285901 *	3285952	3285902 *	3285953	3285903 *

Scalpello per tranciare
Trimming chisel
Trennmeißel

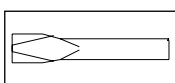

Punteruolo
Drift
Spitzmeißel

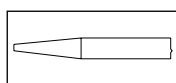

Punzone
Punch
Locher

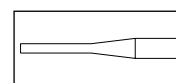

MAC 2 DA	MAC 22/33	MAC 2 DA	MAC 22/33	MAC 2 DA	MAC 22/33
3285954	3285904	3285955	3285905 *	3285957	3285907

Scalpello piatto doppio taglio
Double cut flat chisel
Flachmeißel mit Doppelschneide

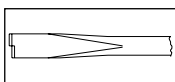

Cacciavite
Screwdriver
Schraubendreher

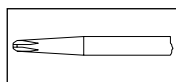

Molla
Spring
Feder

MAC 2 DA	MAC 22/33	MAC 2 DA	MAC 22/33	MAC 2 DA	MAC 22/33
-	3285914 *	3285956	3285906	5084002	5083006

Spianatore
Flattener
Richtmeißel

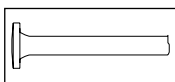

Ribaditore
Riveter
Nietmeißel

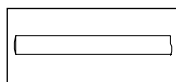

MAC 2 DA	MAC 22/33	MAC 2 DA	MAC 22/33
3285958	3285908	3285959	3285909

* Corredo MAC33 Extra, vedi pag. 6.3 - MAC33 Extra kit, see page 6.3 - Ausstattung MAC33 Extra, siehe Seite 6.3.

Accessori per rivettatrice

Accessories for riveters

Zubehör für Nietwerkzeuge

Kit di riattrezzamento

Retooling kit

Umrüstset

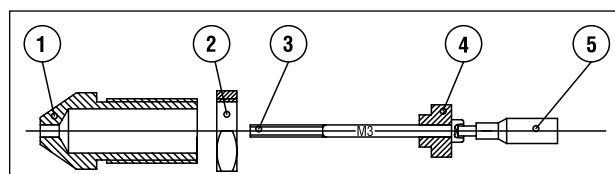

Codice Code Bestellnr.		Naso Tip Nase 1	Dado Nut Mutter 2	Vite Screw Schraube 3	Boccola Bush Buchse 4	Inserto Insert Einsatz 5
7980173	M3	5100047.13	5100612	0320360.1	5063127	3631962
7980174	M4	5100047.14	5100612	0320460.1	5063121.04	3631933
7980175	M5	5100047.15	5100612	0320570.1	5063121.05	3631934
7980176	M6	5100047.16	5100612	0320670.1	5063121.06	3631935



Accessori per stilo marcatrice

Accessories for engraving stylus

Zubehör für Gravierstift

Punta
Marking stylus
Spitze

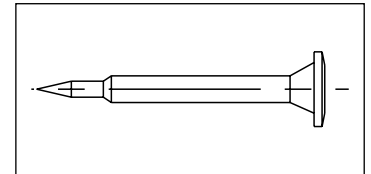

Codice / Code / Bestellnr. | F501106.01

Accessori per seghetto

Accessories for hacksaw

Zubehör für Stichsäge

Lame
Blade
Klinge

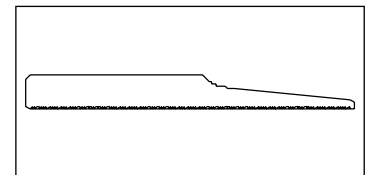

Codice Code Bestellnr.	cod. conf. 5 pz. code for 5-pack Bestellnr. 5-Stück-Packung	Impieghi Uses Einsatzbereich	Configurazione lama Blade specification Sägeblattausführung
3289005	7980110	Ferro, lamiera spessore max mm 2, tagli in curva Sheet metal, max. thickness 2 mm, curve cutting Stahlblech, max. Stärke 2 mm, Bogenschnitte	32 denti per pollice 32 teeth per inch 32 Zähne pro Zoll
3289007	7980111	Ferro max mm 5 - alluminio - legno duro - mat. sintetici Ferrous metal, max. 5 mm - aluminium - hardwood - synthetic material Stahl, max. 5 mm - Aluminium - Hartholz - Kunststoffe	24 denti per pollice 24 teeth per inch 24 Zähne pro Zoll
3289015	7980113	Legno Wood Holz	18 denti per pollice 18 teeth per inch 18 Zähne pro Zoll
3289016	-	Legno Wood Holz	14 denti per pollice 14 teeth per inch 14 Zähne pro Zoll
3289025	-	Gomma tenera - stoffa - cartone - polistirolo Soft rubber - fabric - cardboard - polystyrene Weichgummi - Stoff - Karton - Polystyrol	a coltello knife blade Messer
3289040	-	Marmo - vetroresina Marble - glass fibre Marmor - Glasfaserkunststoff	diamantata fine fine diamond Diamant fein
3289041	-	Marmo - vetroresina Marble - glass fibre Marmor - Glasfaserkunststoff	diamantata media medium diamond Diamant mittel
3289042	-	Marmo - vetroresina Marble - glass fibre Marmor - Glasfaserkunststoff	diamantata grossa coarse diamond Diamant grob

Accessori per rifilatori

Accessories for trimmer

Zubehör für Kantenfräsen

Fresa
Miller
Fräser

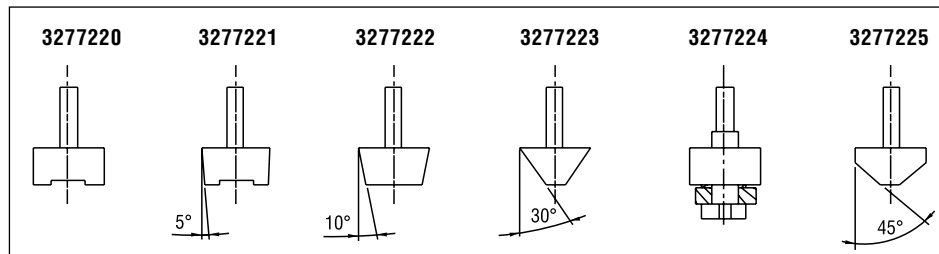

Codice / Code / Bestellnr.	3277220	3277221	3277222	3277223	3277224	3277225
gambo / shank / Schaft	6	6	6	6	6	6
ø mm	6	6	6	6	6	6
taglienti riportati in widia Widia tipped cutters Hartmetall-bestückte Schneiden	PARALLELA PARALLEL PARALLEL	INCLINATA 5° 5° ANGLE GENEIGT 5°	INCLINATA 10° 10° ANGLE GENEIGT 10°	INCLINATA 30° 30° ANGLE GENEIGT 30°	CON RULLINO WITH ROLLER MIT ROLLE	SMUSSO A 45° 45° BEVEL FASE 45°
ø max mm 21						

Pinze
Collets
Spannzangen

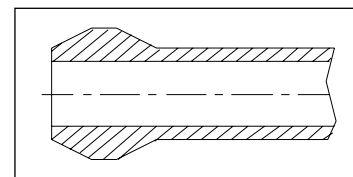

Codice / Code / Bestellnr.	5132102	5132137
ø mm	6	1/4

Chiavi a bocca per serraggio pinza
Collet spanner (open-ended)
Maulschlüssel für Spannzange

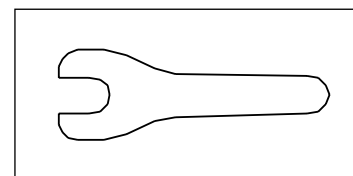

Codice / Code / Bestellnr.	3649104
mm	14